

NOTE:

PRIOR TO ANY INTERIOR SIP TAPE APPLICATION, ALL EXTERIOR ROOF AND WALL SURFACES MUST HAVE WEATHER RESISTANT BARRIERS APPLIED TO ROOF AND WALLS. SIP TAPE SHALL BE INSTALLED EITHER INTERIOR OR EXTERIOR BASED ON CODE REQUIREMENTS AND LOCAL CLIMATE CONDITIONS. CONSULT WITH A BUILDING SCIENCE PROFESSIONAL TO DETERMINE THE LOCATION OF SIP TAPE APPLICATION ON YOUR STRUCTURE. REFER TO PBS-105B FOR EXTERIOR APPLICATION.

TAPE APPLICATION SEQUENCE:

1. APPLY TAPE TO JOINTS OVER BEAMS

ROLL OUT TAPE CENTERED OVER BEAM PRIOR TO SIP INSTALLATION AND SECURE TEMPORARILY WITH STAPLES. AFTER SIPS ARE INSTALLED AND SECURED OVER TAPE, REMOVE BACKING, PRESS FIRMLY INTO PLACE, AND FIRMLY ROLL.

2. INSTALL SIPS

IF RAIN IS OCCURRING AT TIME OF SIP ROOF INSTALLATION RUN A BEAD OF SEALANT AT EXTERIOR SIP JOINT TO PREVENT MOISTURE PENETRATION INTO SPLINE JOINT. IF YOU BELIEVE RAIN WILL BE LIKELY DURING INSTALLATION CONTACT YOUR SIP REPRESENTATIVE TO PURCHASE ADDITIONAL SEALANT.

3. APPLY SIP TAPE TO WALLS AND ROOF SIPS

DO NOT APPLY SIP TAPE ON THE UNDERSIDE OF ROOF SIPS PRIOR TO THE INSTALLATION OF ROOFING UNDERLAYMENT AND ROOF COVERING.

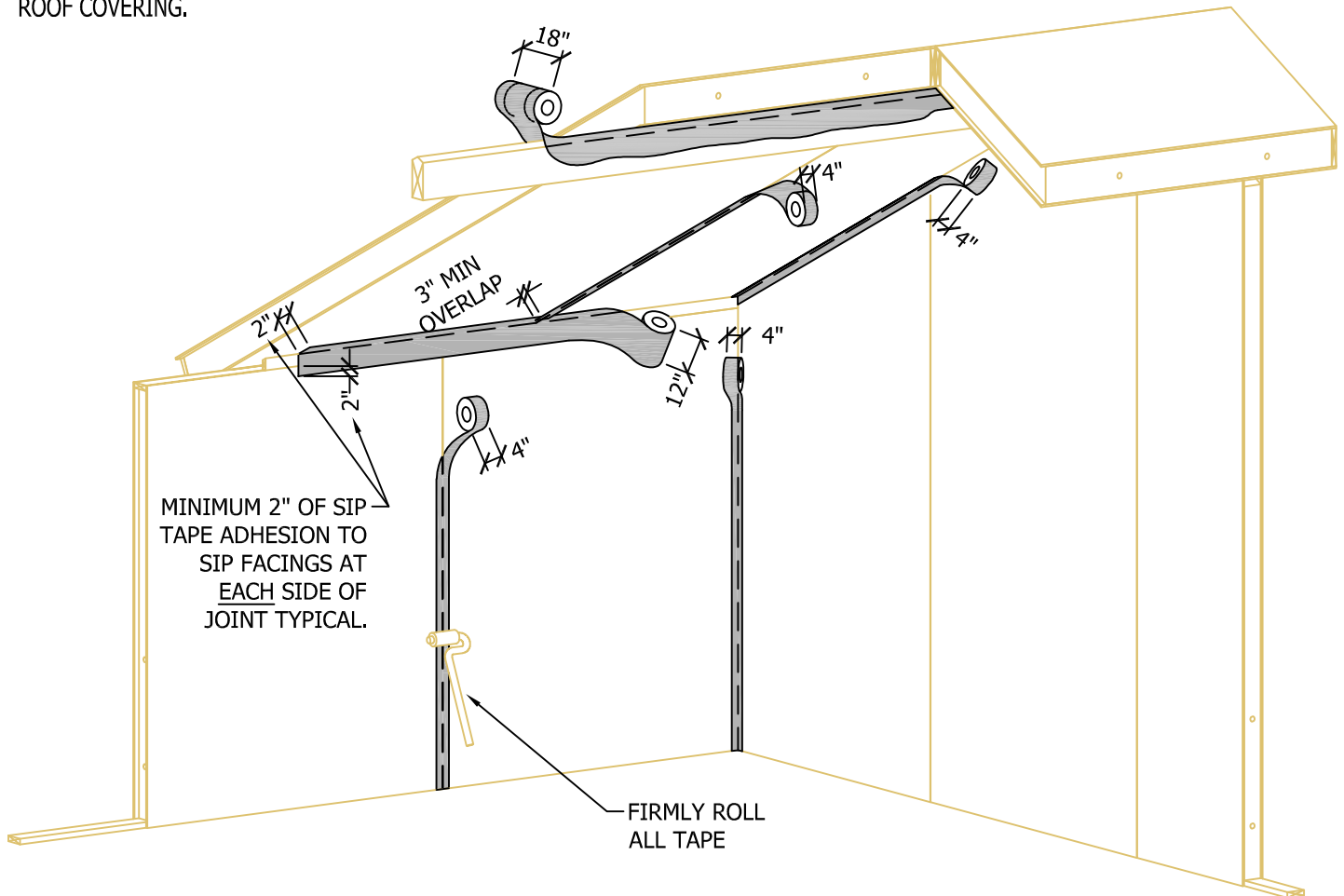

N.T.S.

Rev: 12/10/2021

PBS-105A

SIP TAPE APPLICATION
INTERIOR

PREMIER
OSIPS

