

NAILSTRIP

A one-step insulation and nailable surface.

R-Shield® Nailstrip consists of factory installed furring strips and UL Classified R-Shield insulation rigid insulation. It is an ideal insulation and nailable surface when applied over structurally sound walls such as poured concrete, concrete block, brick, wood, and steel framing. Stability makes R-Shield Nailstrip perfect for both interior and exterior residential and commercial wall applications.

- Saves labor with one-step installation
- Various size panels are available - 16" or 24" o.c.
- Saves energy - no thermal breaks
- Interior - eliminates labor intensive framing
- Exterior - retrofit can occur without disruption of inside living areas

Thickness/R-value.

 R-SHIELD NAILSTRIP Thickness	R-value ¹	
	75°F ²	40°F ³
1 1/2	5.8	6.3
2	7.7	8.3
2 1/2	9.6	10.4
3	11.6	12.5
3 1/2	13.5	14.6
4	15.4	16.7
4 1/2	17.3	18.8

¹ R-value units are °F-ft²-h/Btu.

² Recommended for design in WARM climates.

³ Recommended for design in COLD climates.

Proven to meet, or exceed, building codes.

R-Shield is manufactured under an industry leading quality control program monitored by UL and further recognized in UL Evaluation Report UL ER40361-01 and ICC ESR-4743. R-Shield meets ASTM C578, "Standard Specification for Rigid, Cellular Polystyrene Thermal Insulation".

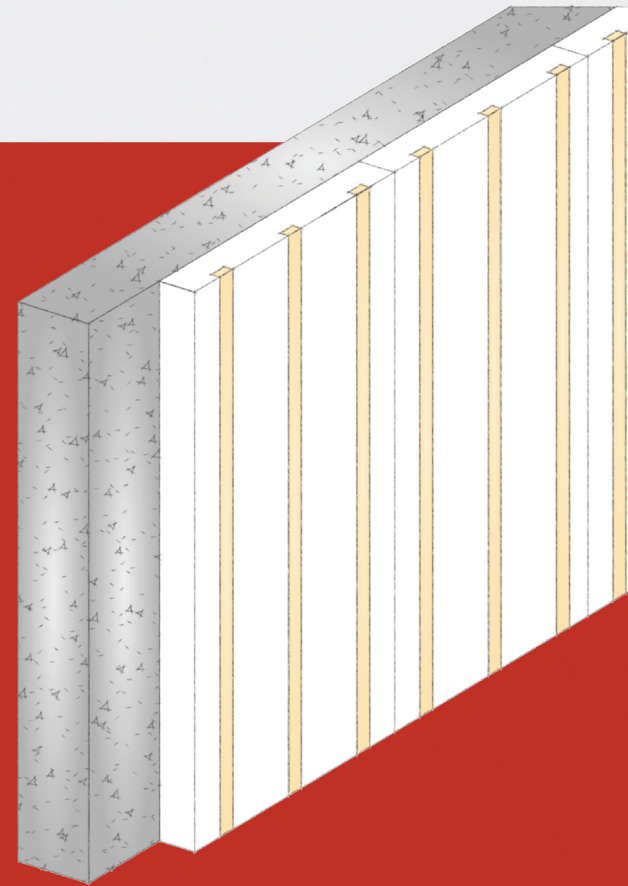

FOAM FACTS:

R-Shield Nailstrip outperforms other products.

- Factory installed furring strips at 16" or 24" o.c.
- R-Shield can easily vary strength, thickness, and size to meet project R-values
- R-Shield is less-expensive than XPS and ISO products
- No long-term R-value loss or thermal drift
- R-Shield with termite treatment available to provide termite resistance

Energy Code Ci Requirements.

The use of continuous insulation is mandated by the 2021 International Energy Conservation Code (IECC). The IECC provides a prescriptive path for wall thermal insulation that includes the use of continuous insulation.

Walls, above grade			
Zone	IECC-2021 Prescriptive Ci R-value		
	Residential	Commercial	
	Wood-Framed Wall	Wood-Framed	
		All other	Group R
0-1	None	R-3.8 ¹	R-3.8 ¹
2	None	R-3.8 ¹	R-3.8 ¹
3	R-5 ¹	R-3.8 ¹	R-3.8 ¹
4 except Marine	R-5 ² R-10 ¹	R-3.8 ¹	R-3.8 ¹
5 and 4 Marine	R-5 ¹	R-3.8 ² R-7.5 ¹	R-3.8 ² R-7.5 ¹
6	R-5 ² R-10 ¹	R-3.8 ² R-7.5 ¹	R-3.8 ² R-7.5 ¹
7	R-5 ² R-10 ¹	R-3.8 ² R-7.5 ¹	R-3.8 ² R-7.5 ¹
8	R-5 ² R-10 ¹	R-18.8 ¹	R-18.8 ¹

¹ For use with R-13 cavity insulation

² For use with R-20 cavity insulation

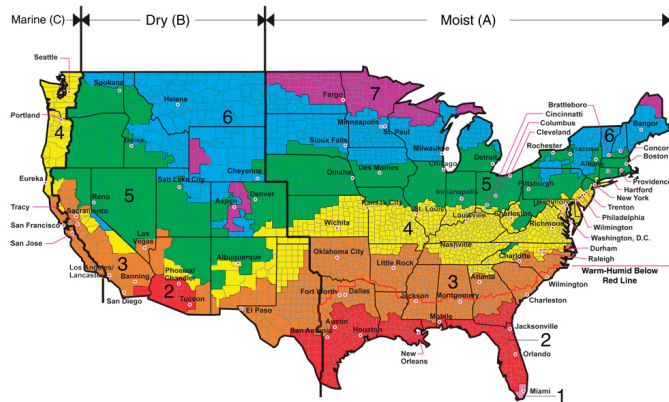

All of Alaska in Zone 7 except for the following Boroughs in Zone 8: Bethel, Dillingham, Fairbanks, N. Star, Nome North Slope, Northwest Arctic, Southeast Fairbanks, Wade Hampton, and Yukon-Koyukuk

Zone 1 includes: Hawaii, Guam, Puerto Rico, and the Virgin Islands

Installation.

Installation shall be in strict accordance with published instructions, details, and drawings that are part of the contract documents for the project.

1. R-Shield Nailstrip must be installed over a structurally sound substrate.
2. Mechanically fasten R-Shield Nailstrip with R-Shield Fasteners or other approved fasteners long enough to penetrate the structural substrate to provide adequate holding power.

Note: Fastener types, installation, and spacing should be designed on an individual project basis. For specific fastening recommendations, please contact a sales representative or refer to the R-Shield Nailstrip Construction Manual and Technical Bulletins.

3. Provide continuous wood or metal blocking at all perimeters and openings.
4. Install weather resistive barriers and wall cladding materials per wall cladding manufacturer's specifications and recommendations for installation over continuous insulation.

Note: Climate conditions, code requirements, and building science dictate the use and position of vapor retarders within wall assemblies. Consult with local code officials and building science professional concerning the use of vapor retarders.

Termite Resistant.

One of the most destructive forces anywhere is termites. R-Shield can be manufactured with a proven and safe additive, that effectively resists termites.

R-Shield is treated to meet ICC ES AC239, "Acceptance Criteria for Termite-Resistant Foam Plastics".

Ready to take control? Start here.

If you're ready to have R-Shield contribute to your next project, just contact your Premier Building Systems Technical Sales Representative. They will be happy to give you design consultation, information about R-Shield products, pricing, and answers to all of your questions.

A PRODUCT OF
PREMIER
BUILDING SYSTEMS



www.rshieldinsulation.com | 800-766-3626

Copyright © 2022. R-Shield is a registered trademark of Premier Building Systems. RSI NS01 08/22