

CRAWL SPACE

Expanded Polystyrene Insulation.

R-Shield® expanded polystyrene insulation is a cost-effective, durable, and energy efficient solution for interior crawl space wall applications. It is an ideal material to stop energy loss through the wall. R-Shield expanded polystyrene is available in a range of thicknesses to meet your local energy code requirements.

- R-value that never changes and is stable over time
- Range of compressive strengths available
- Closed cell insulation with superior moisture resistance
- High drying potential to rapidly release absorbed moisture
- Meets code requirements for continuous insulation

Strength/R-value.

R-SHIELD® RIGID INSULATION	Compressive Strength ¹ , psi	R-value/inch ²	
		75°F ³	40°F ⁴
100	10	3.9	4.2
130	13	3.9	4.3
150	15	4.2	4.6
250	25	4.4	4.8

¹ Compressive strength @ 10% deformation.

² R-value units are °F·ft²·h/Btu.

³ Recommended for design in WARM climates.

⁴ Recommended for design in COLD climates.

R-Shield is available in a wide range of standard R-values and thicknesses to meet your needs. Product thicknesses for standard boards are provided in the R-Shield Thickness & R-value. Project requirements vary, so R-Shield can be ordered in any R-value thicknesses to meet your needs.

Proven to meet, or exceed, building codes.

R-Shield is manufactured under an industry leading quality control program monitored by UL and further recognized in UL Evaluation Report UL ER40361-01 and ICC ESR-4743. R-Shield meets ASTM C578, "Standard Specification for Rigid, Cellular Polystyrene Thermal Insulation".



Approved for use in crawl spaces without a thermal barrier or ignition barrier.

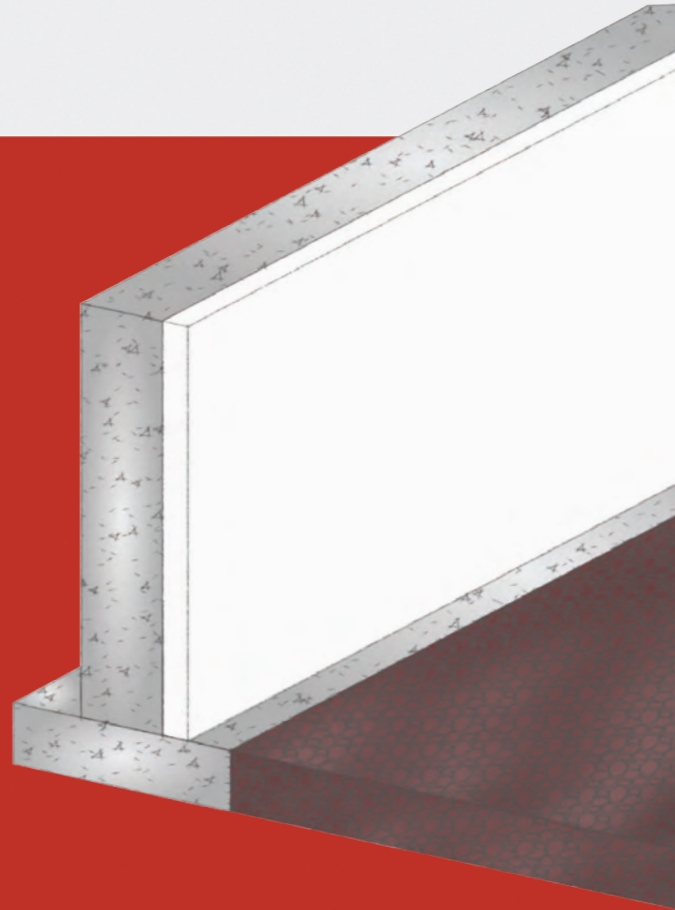

FOAM FACTS:

R-Shield outperforms XPS.

- R-Shield provides a stable long-term R-value at a lower cost
- R-Shield uses a blowing agent with 10 x lower global warming potential and 10,000 x lower ozone depletion
- R-Shield meets strength requirements at a lower cost
- R-Shield and XPS have resistance to moisture, but R-Shield has a higher vapor permeance leading to superior drying potential
- R-Shield with termite treatment available to provide termite resistance

Performance Value.

When you consider all performance characteristics and cost, R-Shield is your best choice for foam insulation.

R-Shield has air in its closed cells and therefore has a stable R-value. Many other insulations use blowing agents that cause R-value loss and are harmful to the environment.

R-Shield has compressive strength to meet specific project requirements.

R-Shield is manufactured to resist moisture absorption in wetting conditions and release absorbed moisture quickly during drying periods, which means R-Shield maintains R-value.

Termite Resistant.

One of the most destructive forces anywhere is termites. R-Shield can be manufactured with a proven and safe additive, that effectively resists termites.

R-Shield is treated to meet ICC ES AC239, "Acceptance Criteria for Termite-Resistant Foam Plastics".

Recyclable.

After it's life as a building insulation, R-Shield is 100% recyclable. It can be ground into granules and reincorporated into new R-Shield products or it can be thermally processed into a resin that's used to manufacture other new products.

Ready to take control? Start here.

If you're ready to have R-Shield contribute to your next project, just contact your Premier Building Systems Technical Sales Representative. They will be happy to give you design consultation, information about R-Shield products, pricing, and answers to all of your questions.

A PRODUCT OF
PREMIER
BUILDING SYSTEMS



www.rshieldinsulation.com | 800-766-3626

Copyright © 2022. R-Shield is a registered trademark of Premier Building Systems. RSI 19 08/22